

# MEK.A.NiK.A

DUST SHOE  
MOUNTING GUIDE 43 MM

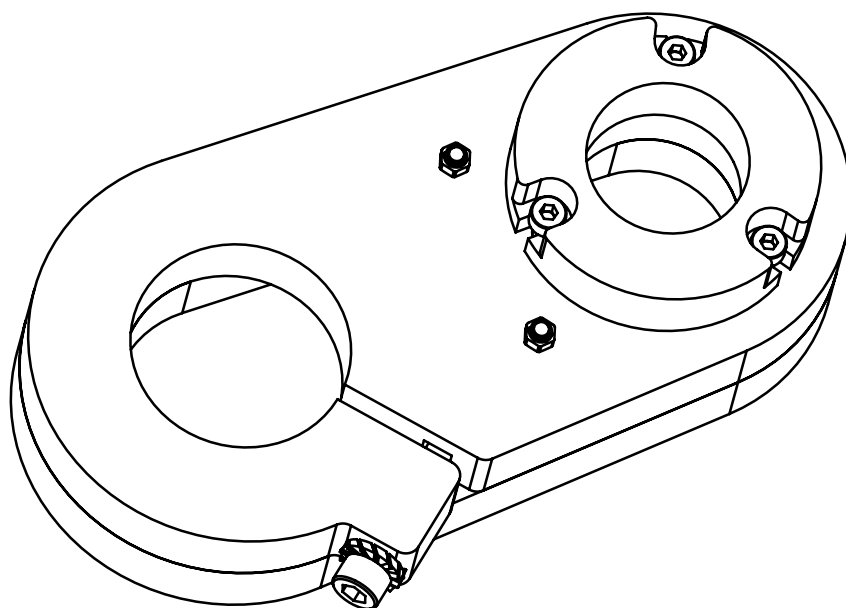

# DUST SHOE

## VERSIONS

### Closed Ring version

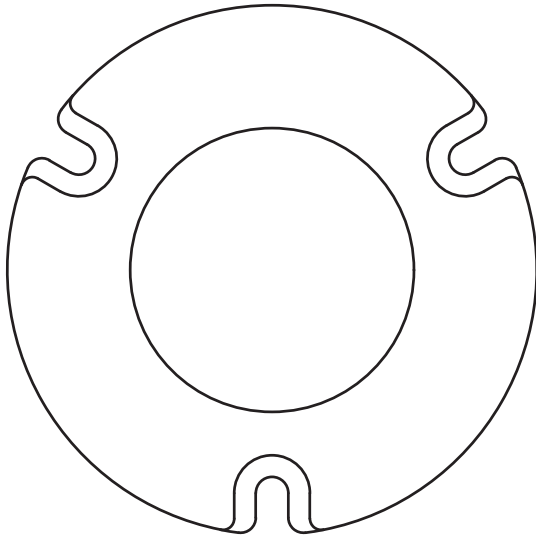

If you identify this clamping ring,  
**go straight to the next page to  
start the assembly.**

### Opened Ring version

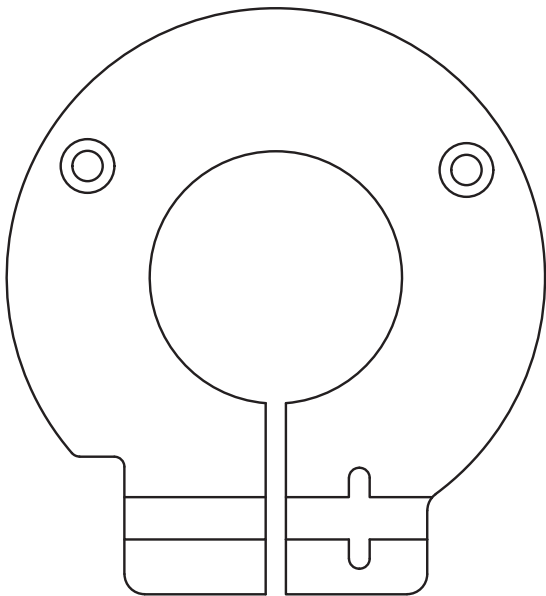

If you identify this clamping ring,  
**go straight to the page 7 to start  
the assembly.**

# DUST SHOE

## MOUNTING GUIDE

### Closed Ring version

1

Assemble the Plexiglas parts with the three M4x20 screws as shown. Place the three M4 locknuts in the triangular holes so that they lock when tightened.

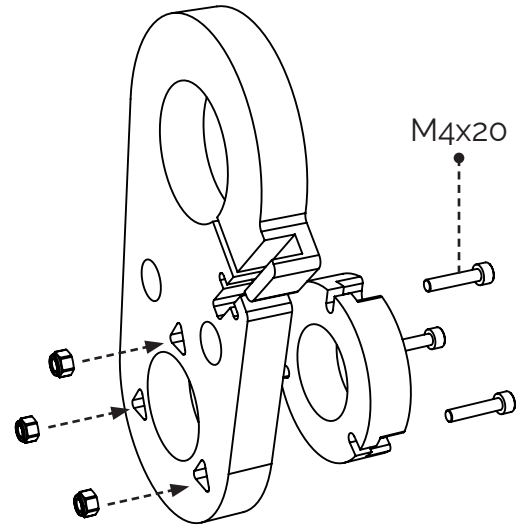

2

Attach the two chamfered washers with the M3x12 screws as shown. Use the M3 lock nuts to tighten them.

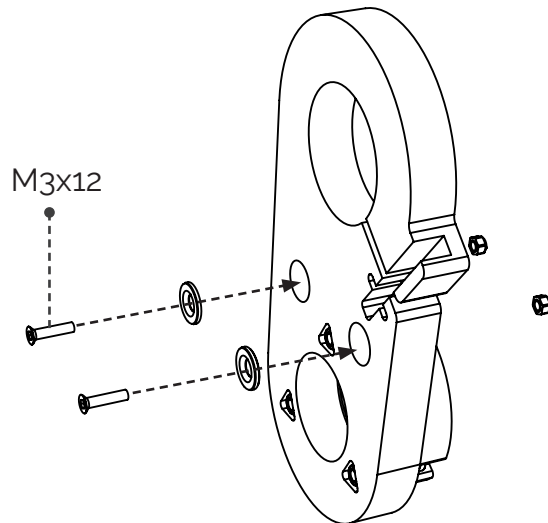

3

Place the M6 rectangular nut in the provided pin. Tighten the M6x40 screw with the tooth lock washer. Do not fully tighten at this stage

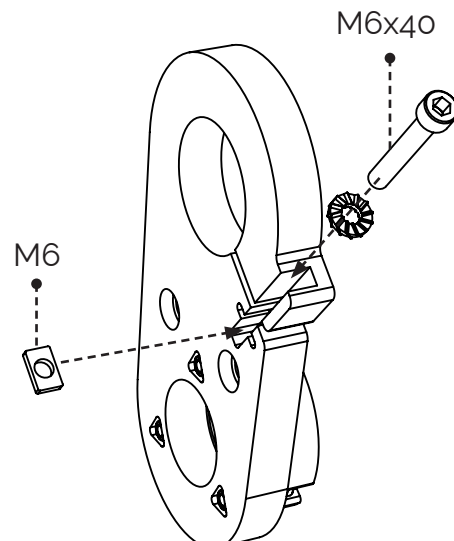

# DUST SHOE

## MOUNTING GUIDE

### Closed Ring version

4

To ensure a good fit of the aluminium connector, it is necessary to glue it to the acrylic ring.

1. Apply cyanoacrylate glue (super glue) all around the foam seal
2. Insert the aluminium tube into the ring as shown
3. Wait a few minutes before handling the dust shoe

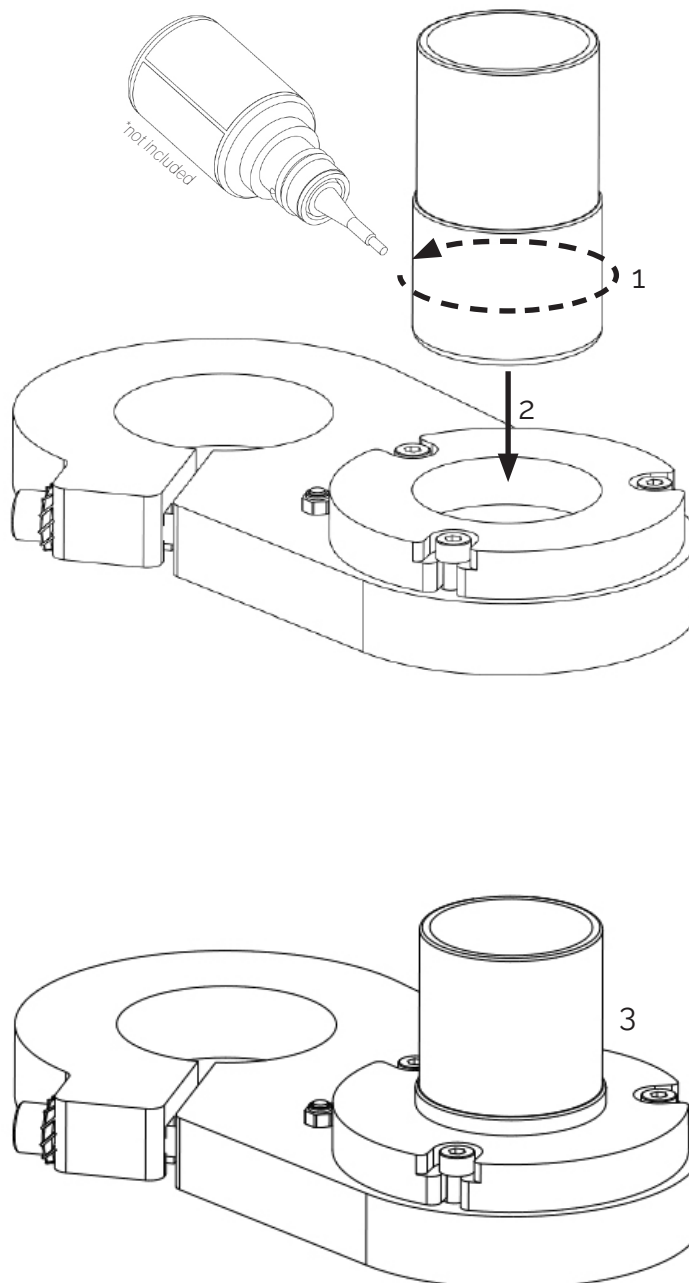

# DUST SHOE

## MOUNTING GUIDE

### Closed Ring version

5

Attach the 2 magnets with the two M3x10 screws as shown.

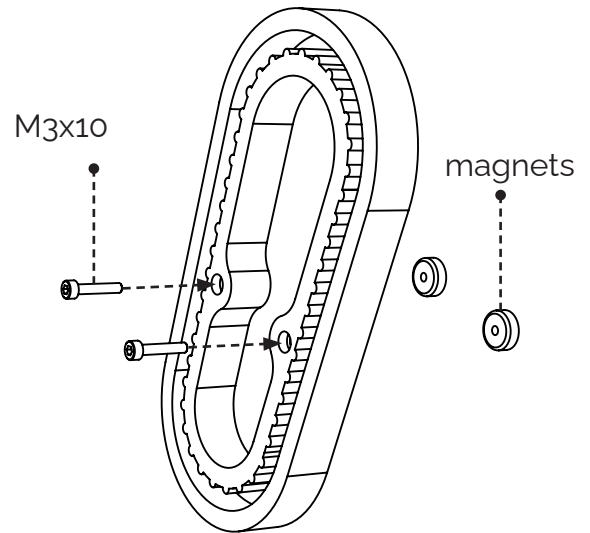

6

Push the brush into the tightening notch provided for this purpose.

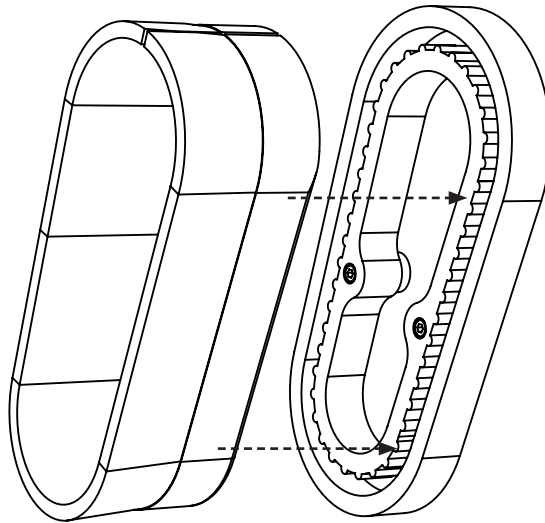

# DUST SHOE

## MOUNTING GUIDE

### Closed Ring version

7

Place the fixed part of the dust shoe on the spindle and tighten it with the 5mm Allen key.

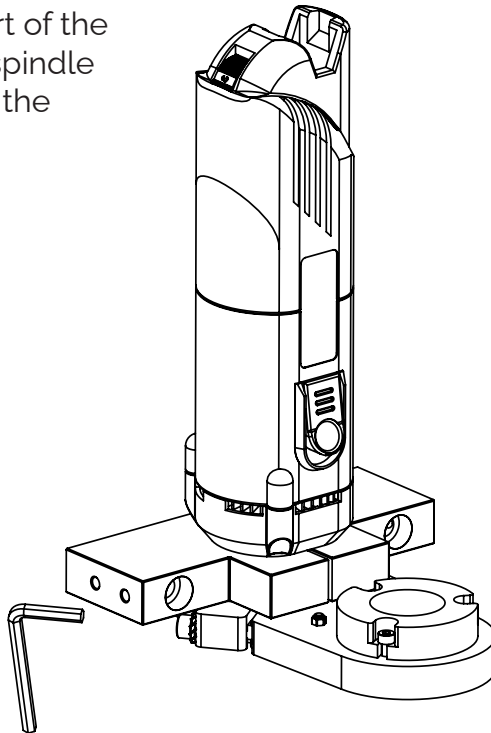

8

Place the bottom part of the dust shoe. The magnets should fit into the notches.

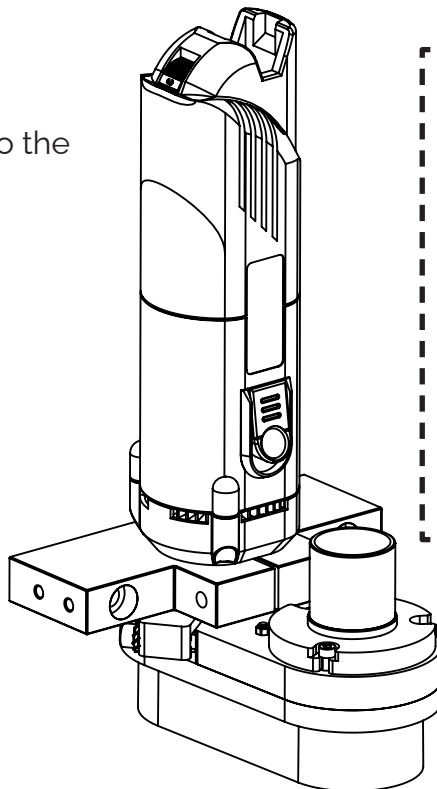

Try to manually pull down the bottom part of the Dust Shoe

If you feel that the magnets attraction is not strong enough, it probably means that the magnets are not touching the chamfered washers.

Go back on STEP#2 and slightly loosen the locknuts to solve that problem.

Repeat the pull down test.



USE THE DUST SHOE ONLY IF THE MAGNETS STICKS CORRECTLY TO THE WASHERS  
(if it's not the case, refer to that note)

# DUST SHOE

## MOUNTING GUIDE

### Opened Ring version

1

Assemble the Plexiglas parts with the two M4x20 screws as shown. Place the two M4 locknuts in the triangular holes so that they lock when tightened.

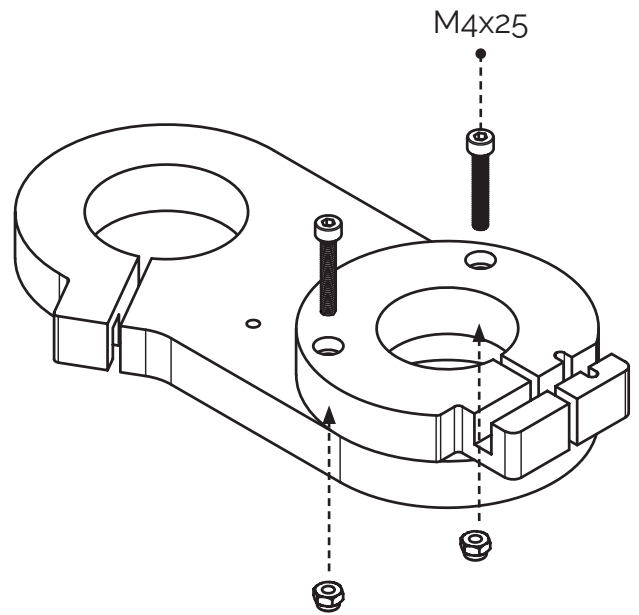

2

Place the M6 rectangular nuts in the provided pin. Tighten the M6x40 screws with the tooth lock washers. **Do not fully tighten at this stage**

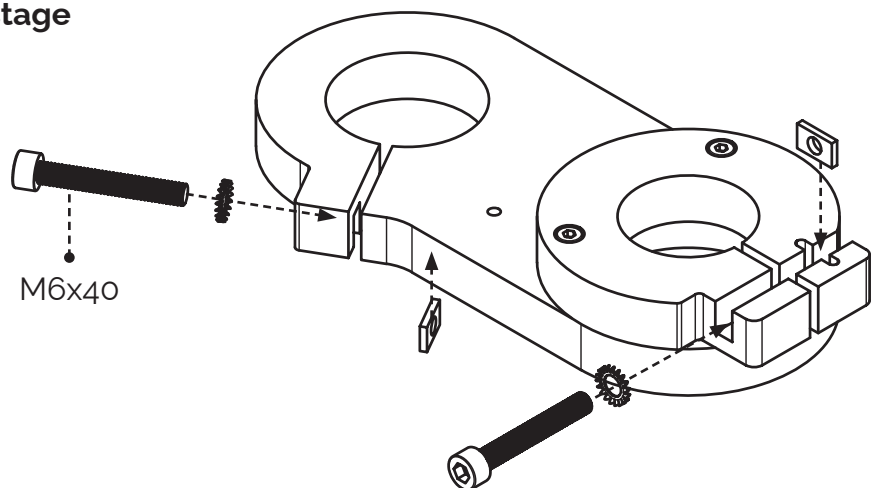

3

Attach the two chamfered washers with the M3x16 screws as shown. Use the M3 lock nuts to tighten them

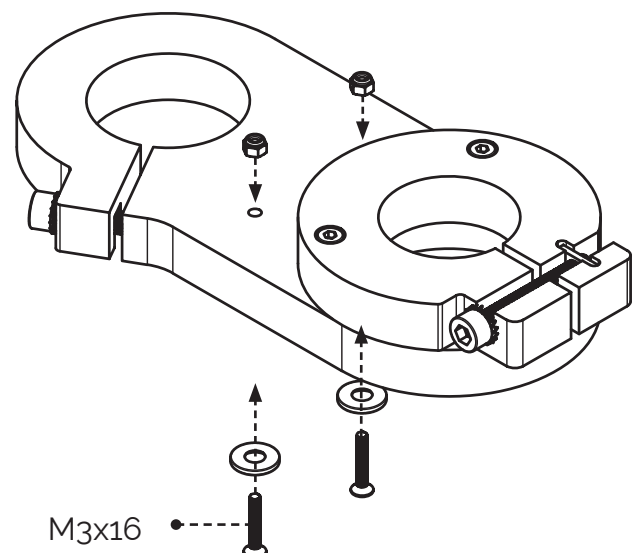

# DUST SHOE

## MOUNTING GUIDE

### Opened Ring version

4

Place the plastic adaptator into the clamping ring and tighten it.

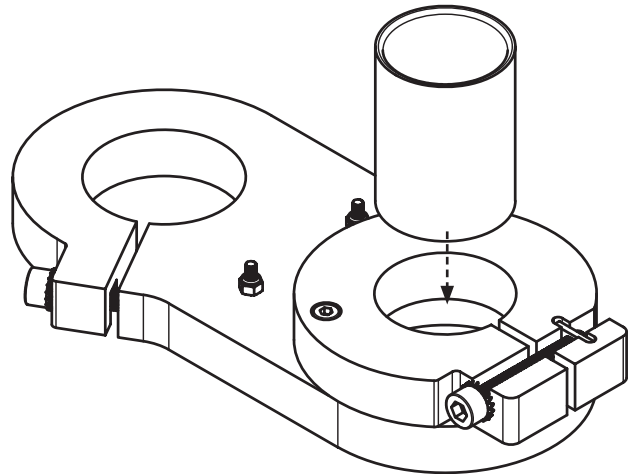

5

Assemble the magnets on the last Plexiglas part as shown with the two M3x10 screws.

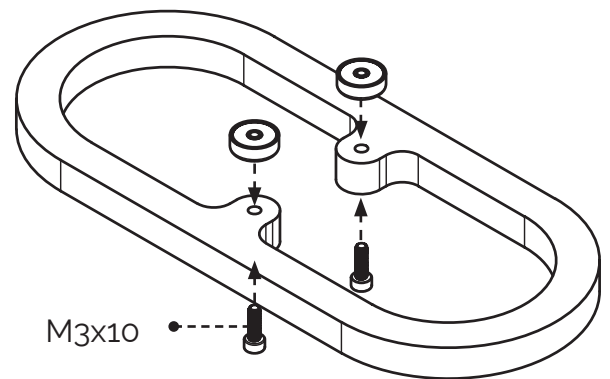

6

Insert the brush\* part in the slot as shown.

*\*You might have to cut the brush to make it fit the slot perfectly*

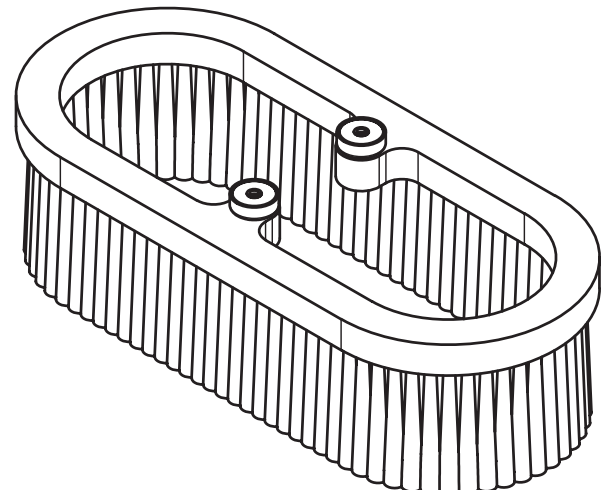



# DUST SHOE

## MOUNTING GUIDE

### Opened Ring version

7

Place the fixed part of the dust shoe on the spindle and tighten it with the 5mm Allen key.

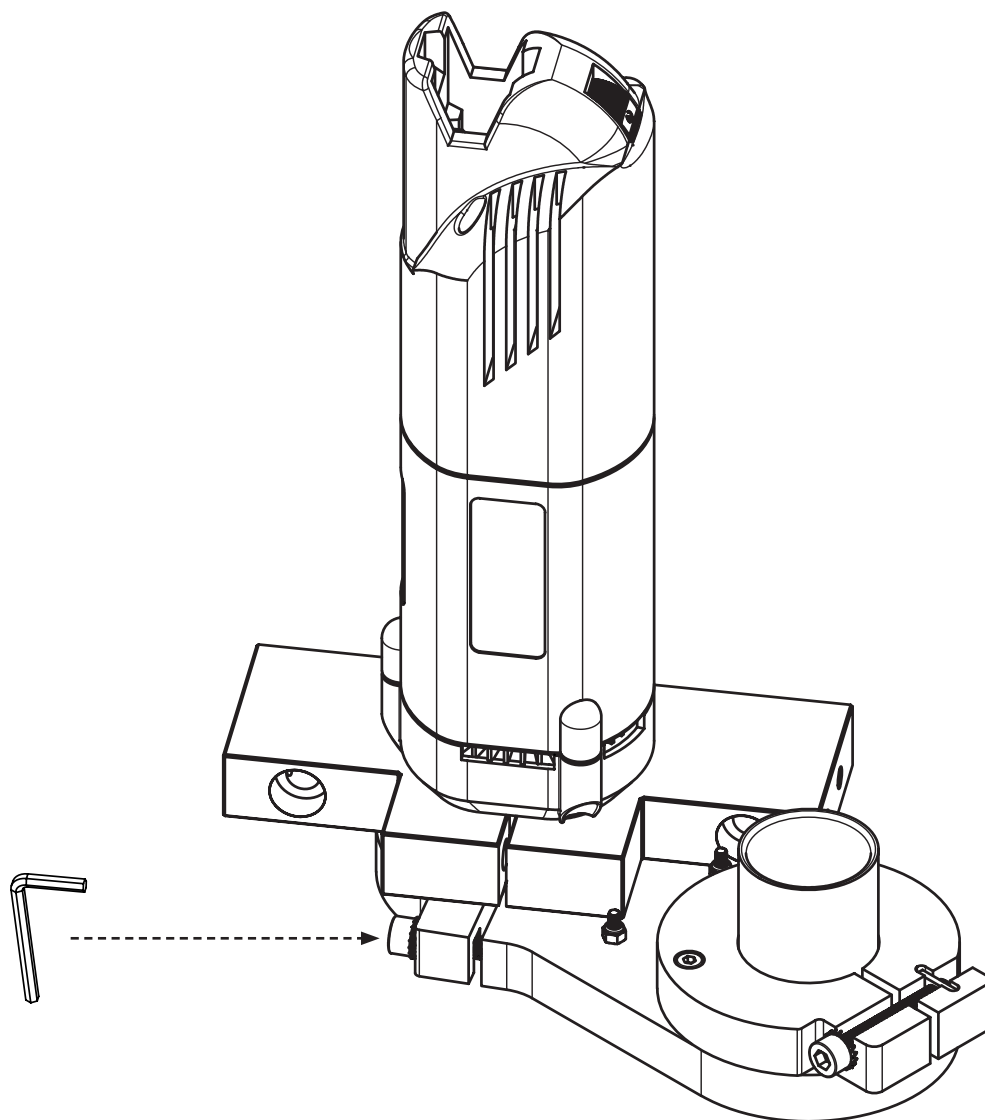

# DUST SHOE

## MOUNTING GUIDE

### Opened Ring version

8

Place the bottom part of the dust shoe. The magnets should fit into the notches.

Try to manually pull down the bottom part of the Dust Shoe

If you feel that the magnets attraction is not strong enough, it probably means that the magnets are not touching the chamfered washers. Slightly loosen the locknuts to solve that problem.

Repeat the pull down test.

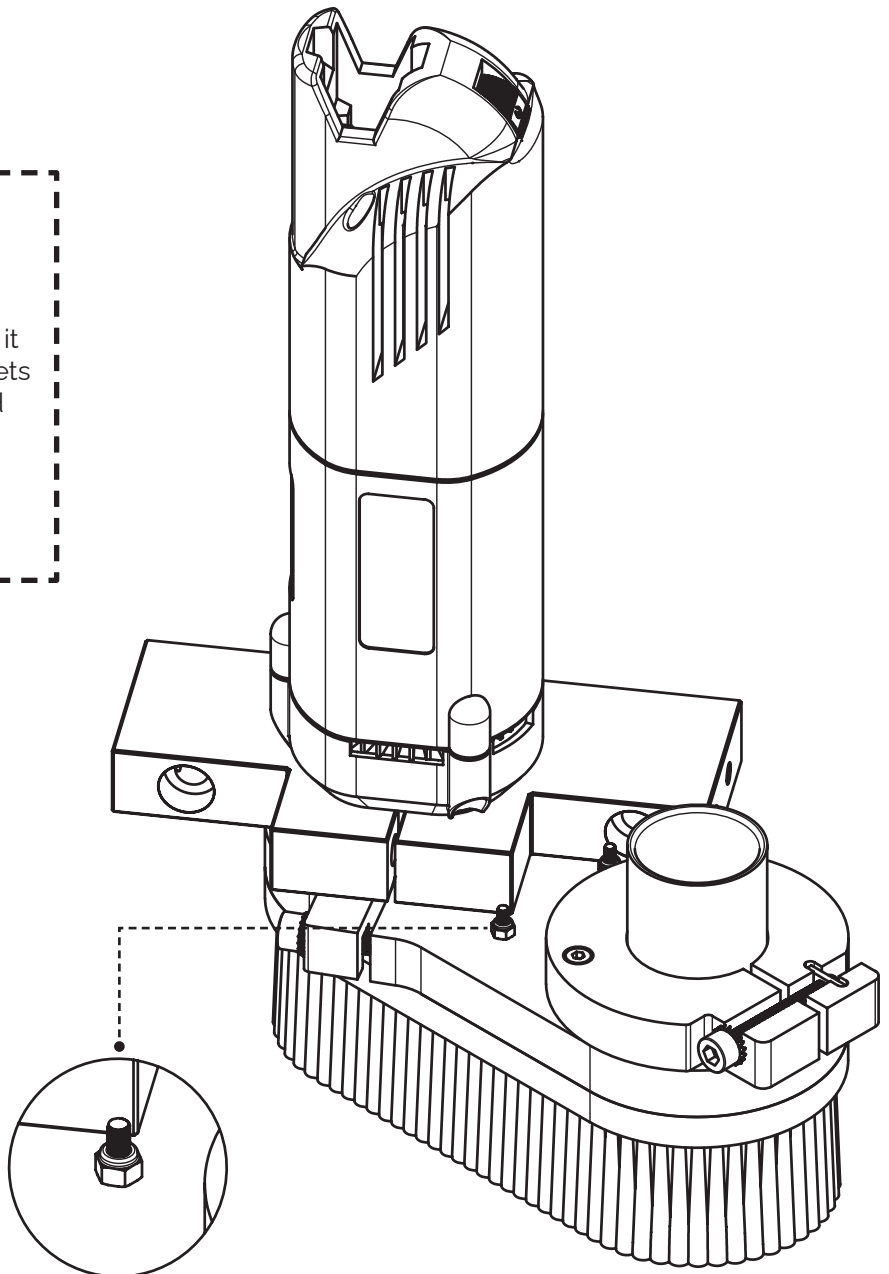

USE THE DUST SHOE ONLY IF THE MAGNETS STICKS  
CORRECTLY TO THE WASHERS  
(if it's not the case, refer to the note above)